

PROJECT ONE

precedent studies & inspiration

concept

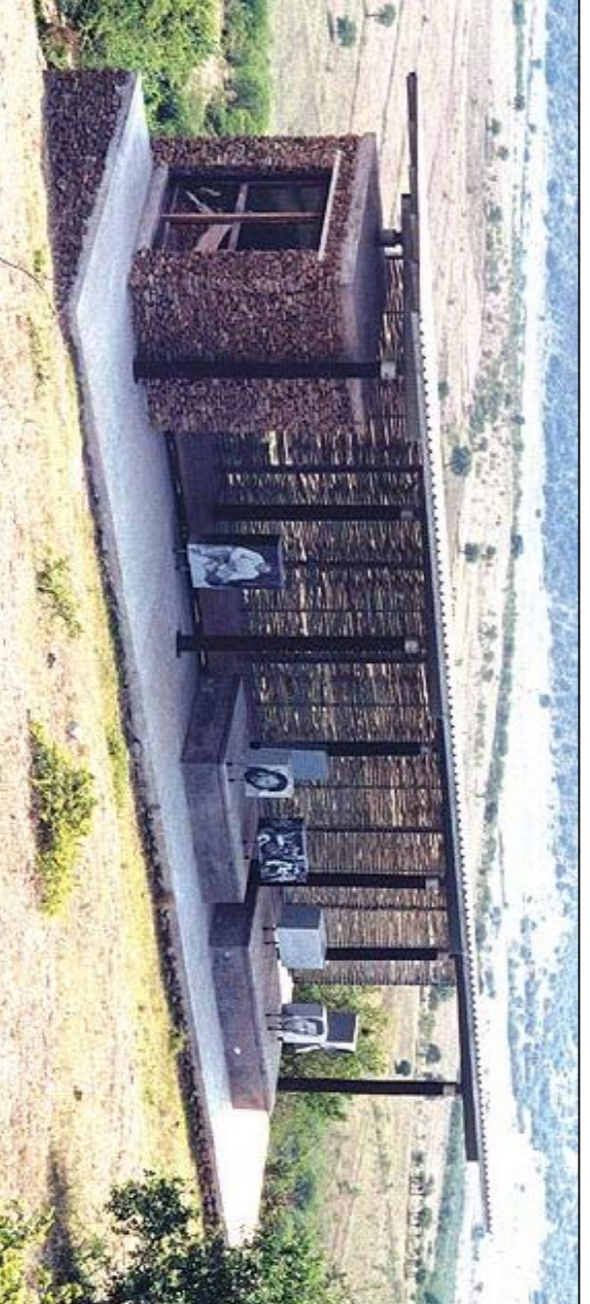
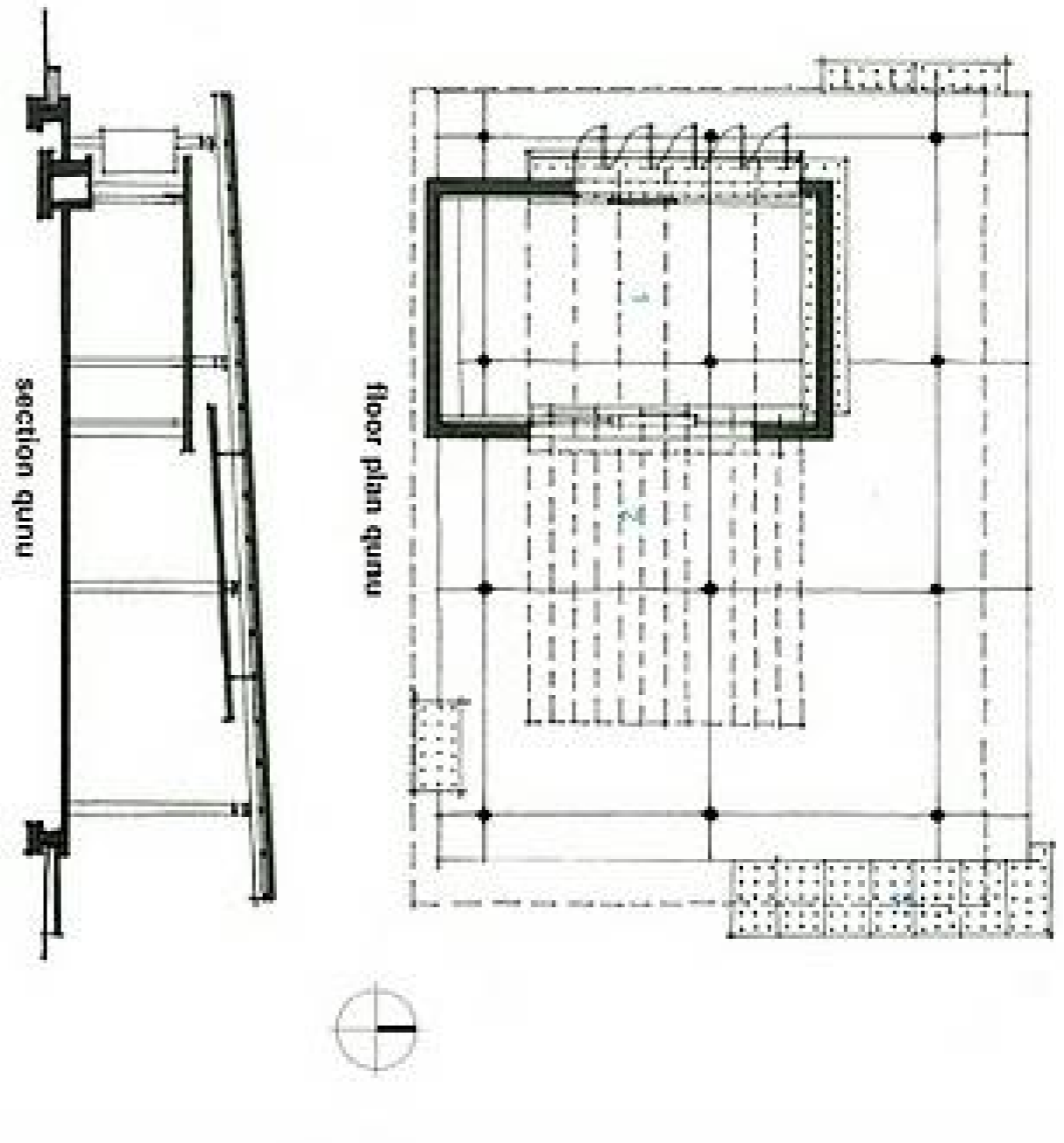

nelson mandela museum, mvezo & qunu, eastern cape

technology - form

play

informative

efficiency

community landmark

functional

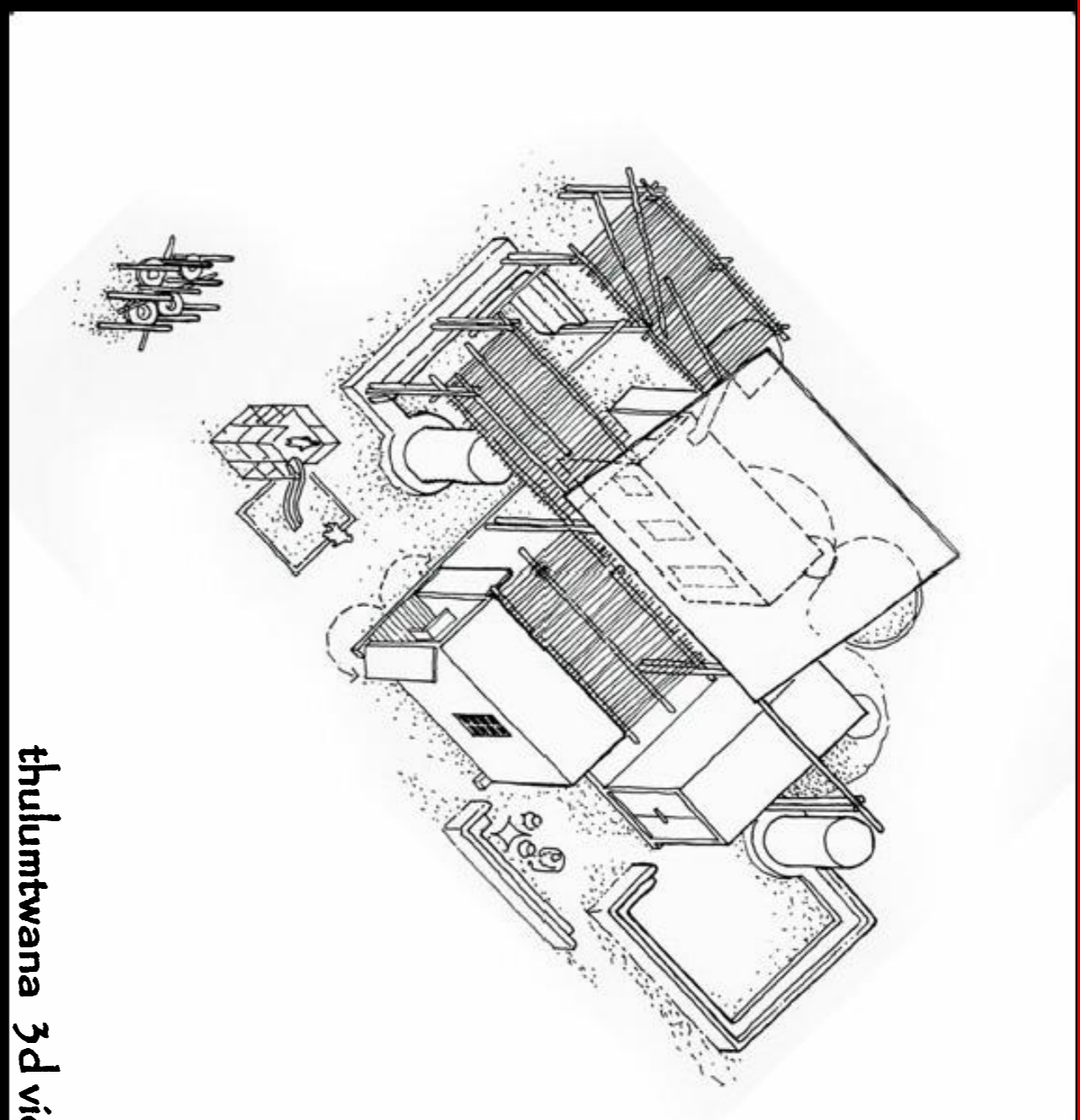
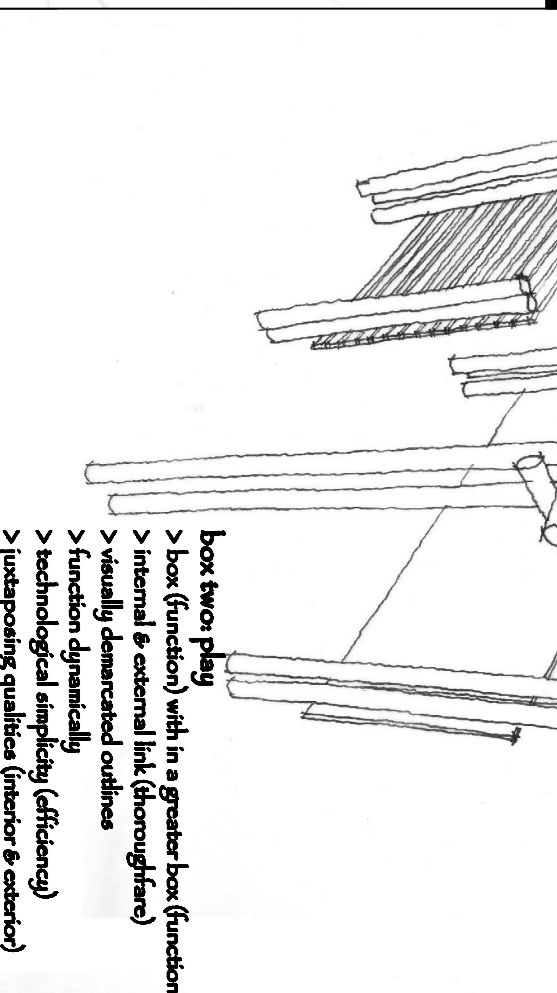
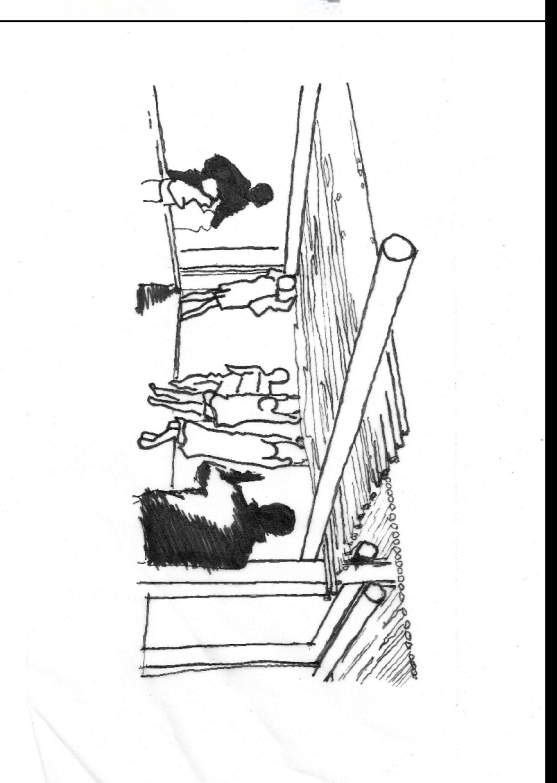
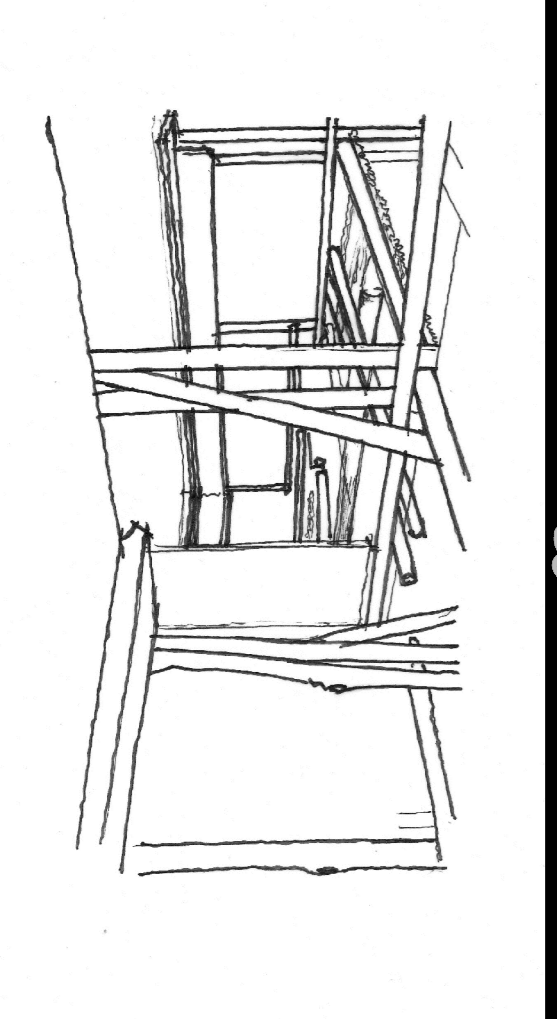

thulumtwana 3d view

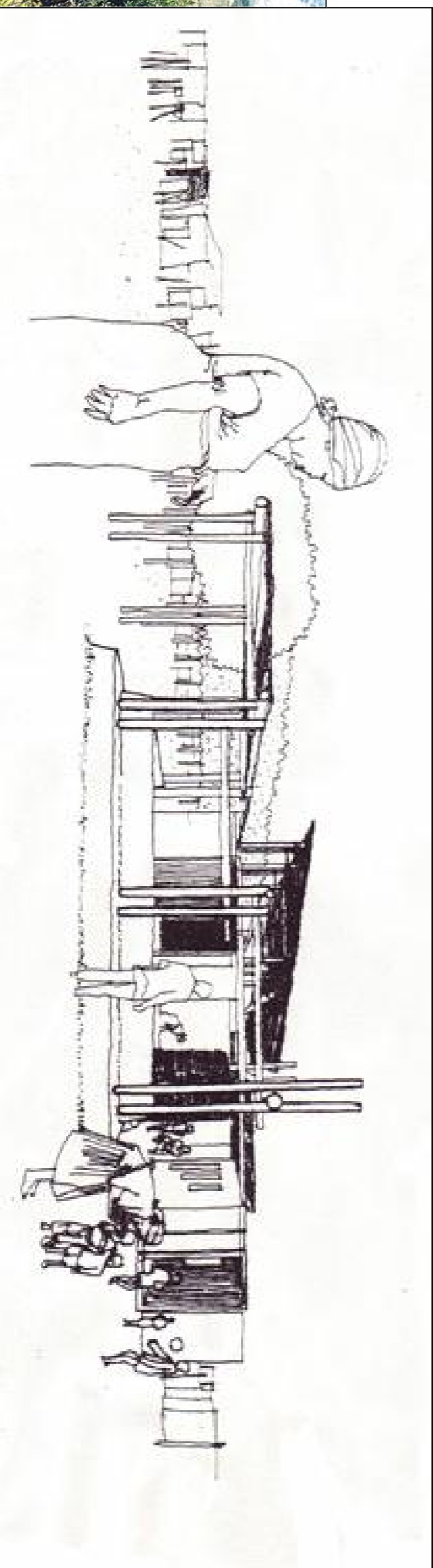
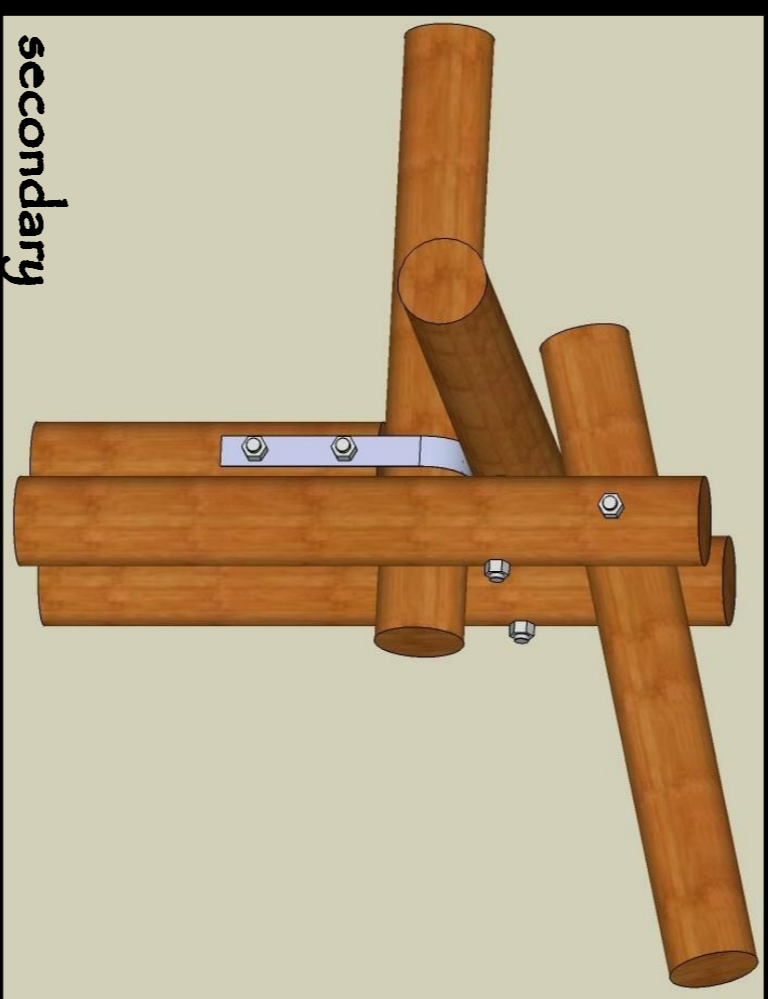
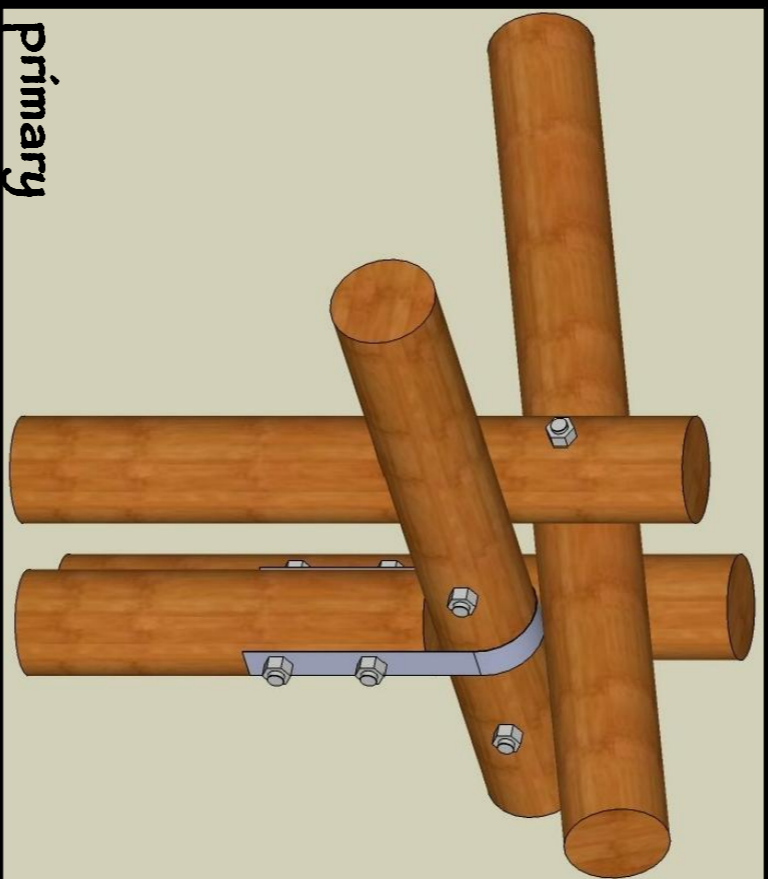
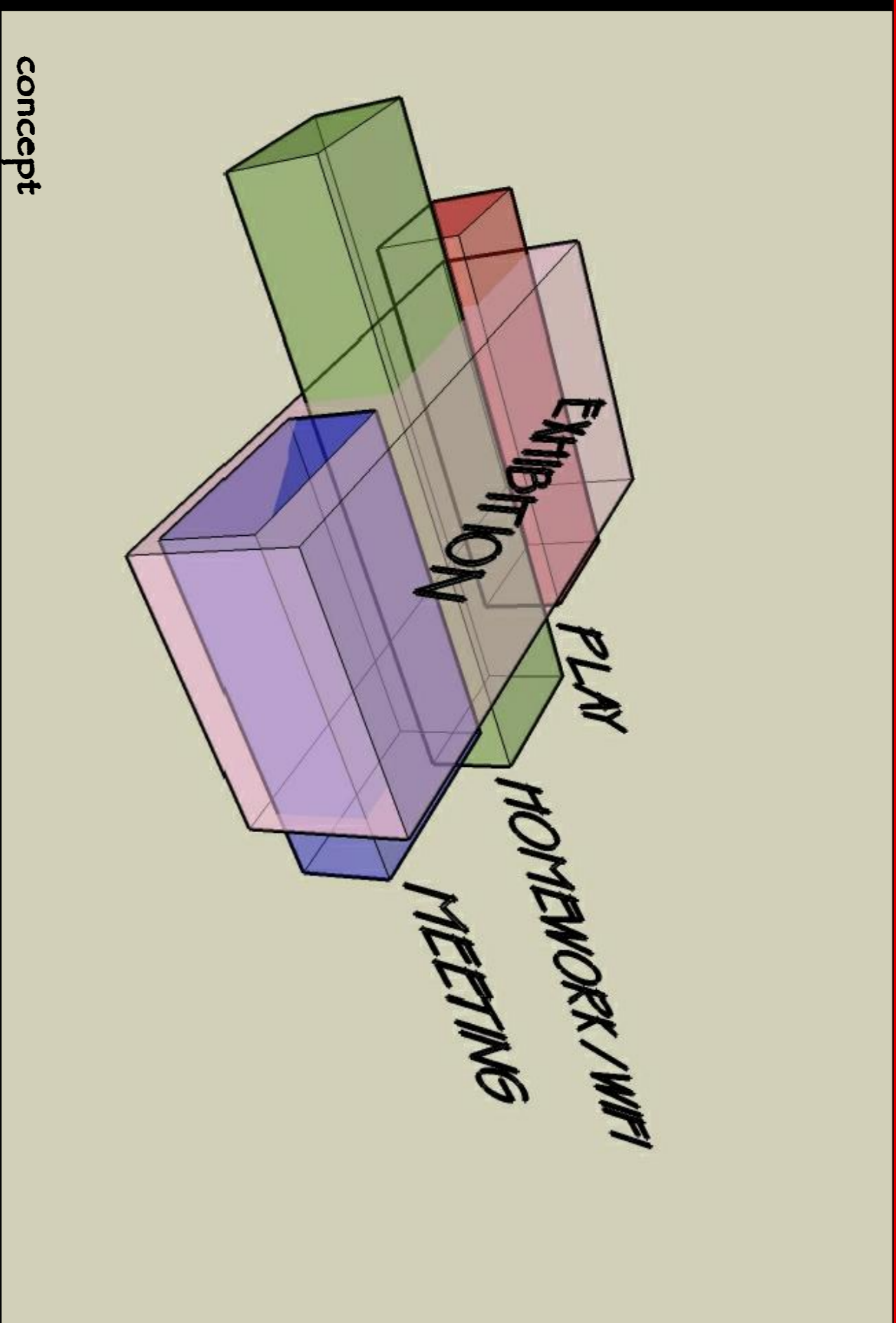

thulumtwana childrens facility peter rich architects

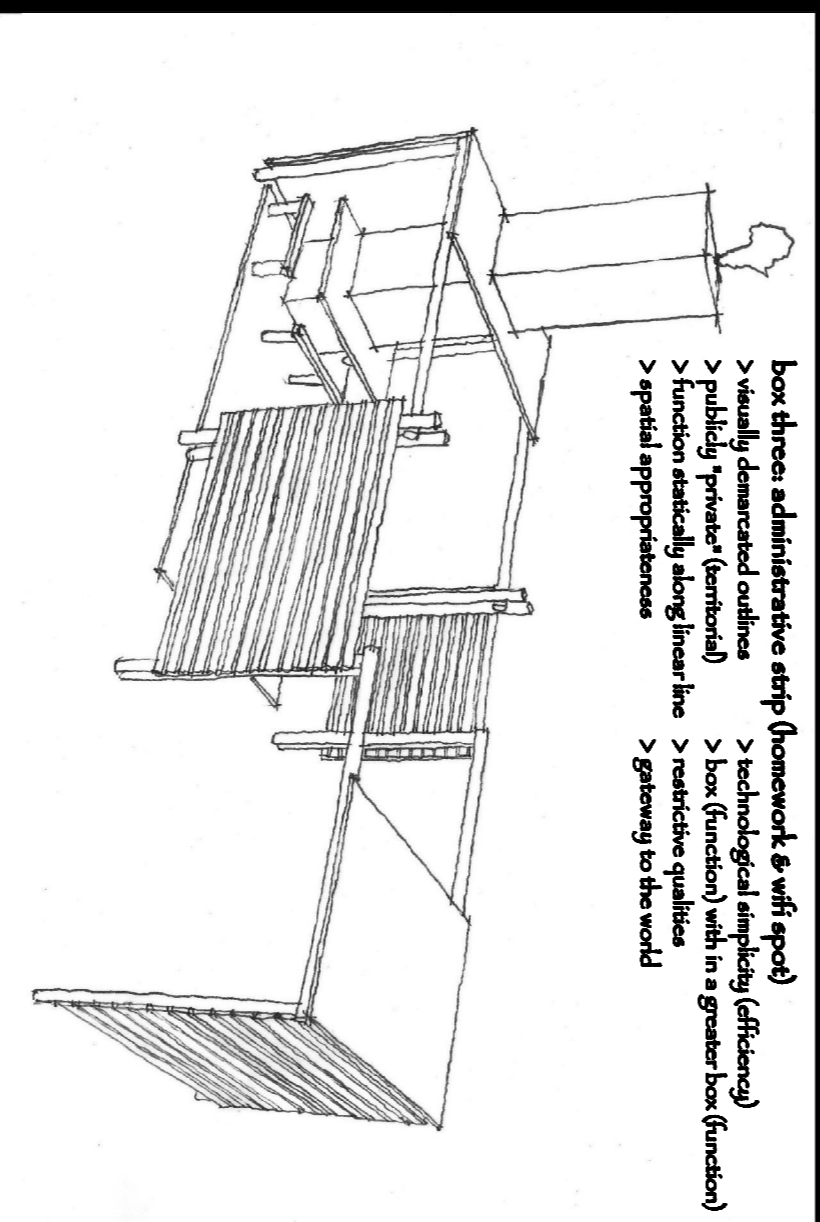

- box three administrative strip (homework & wifi spot)
- > visually connected outlines
- > publicly 'private' (horizontal)
- > function aesthetically along lines
- > spatial appropriateness
- > gateway to the world

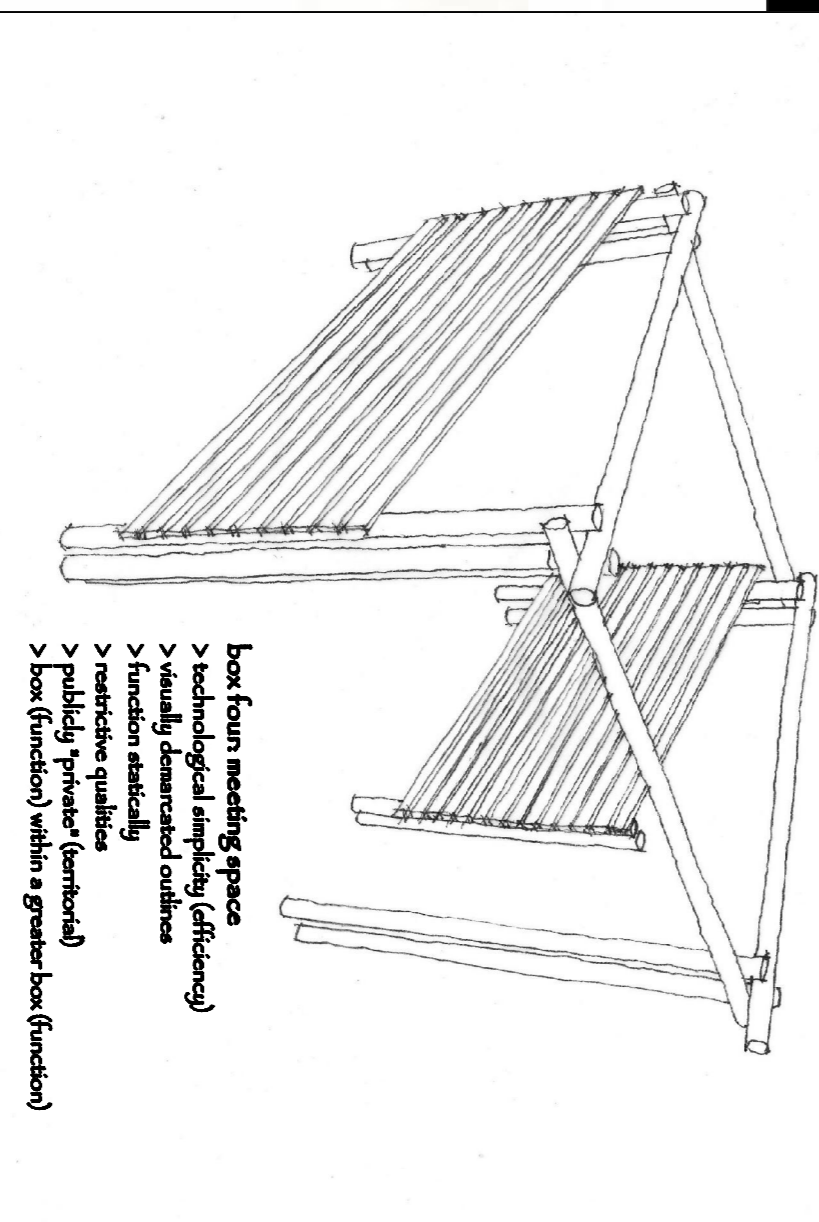

- box four meeting space
- > technological simplicity (efficiency)
- > visually dominated outlines
- > function aesthetically
- > restrictive qualities
- > publicly 'private' (horizontal)
- > box (function) within a greater box (function)